

Command Central

An island kitchen is the true hub of the home.

Rob and Marilyn Wrightman built their log home in Ontario with entertaining in mind. They designed their kitchen with a large island focused on the spacious living room so the cook could face family and friends while prepping and cooking. "We included two full-sized dishwashers," Marilyn notes, calling it "one of the best decisions we ever made."

The dining room is located beside the kitchen in a separate turret with a vaulted ceiling and 180 degrees of windows. The kitchen also enjoys access to two decks.

A wraparound island helps the cook keep an eye on the great room.

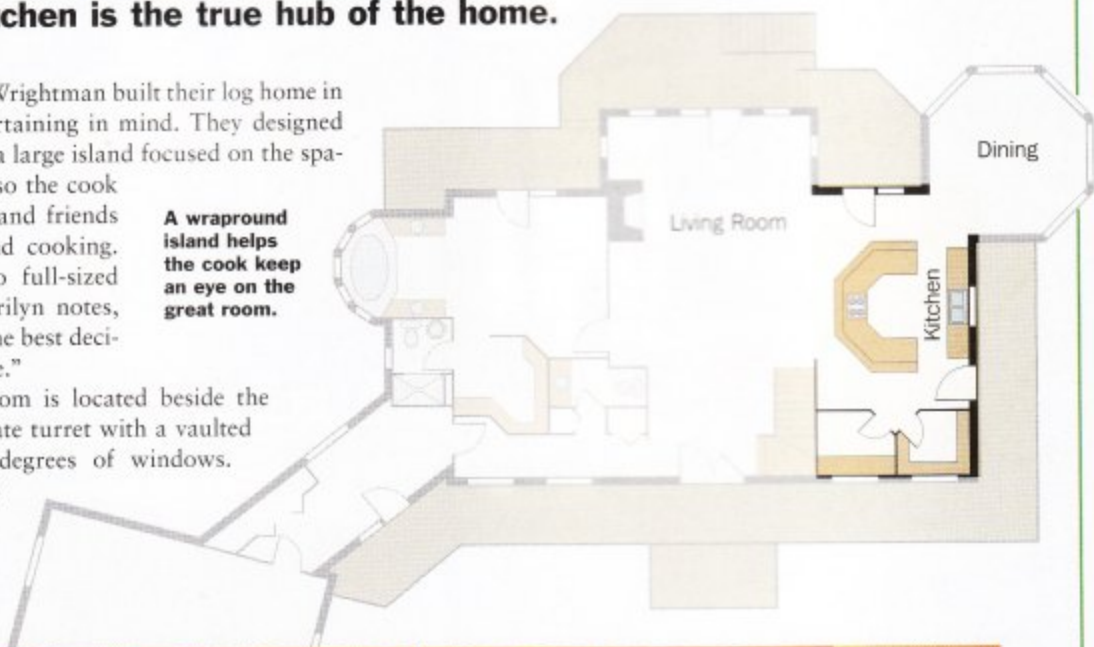

True North Log Homes photo; RIGHT: J. K. Lawrence photo, Simpson Door Company photo